

Courses & Distances

N 47 W 99
 N 44 E 252
 S 63 E 146
 S 51 1/2 E 28
 S 57 W 303 1/2

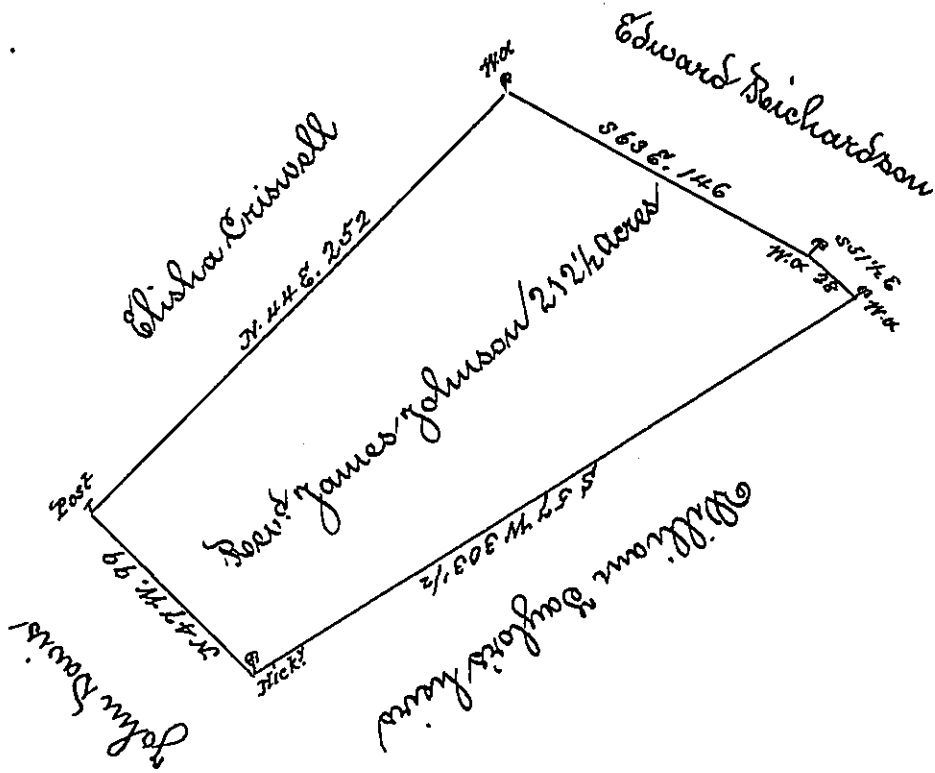

The Draught of a tract of land called _____ situated in Armanagh Township Cumberland County containing two hundred & twelve acres & an half & the usual allowance of six p^{ct}. Cent. for roads &c^e surveyed for the Reverend James Johnson May the 2^d 1785 in pursuance of a warrant from the Honorable the Vice President of the Supreme Executive Council Dated the 5^d day of March 1785 -

John Coukens Esq^r. Surv^r. Genl.

Jas Harris D. S.

IN TESTIMONY that the above is a copy of the original remaining on file in the Department of Internal Affairs of Pennsylvania, made conformably to an Act of Assembly approved the 16th day of February, 1833, I have hereunto set my Hand and caused the Seal of said Department to be affixed at Harrisburg, this second day of August 1898.

James W. Fatta
 Secretary of Internal Affairs.